

The ceiling

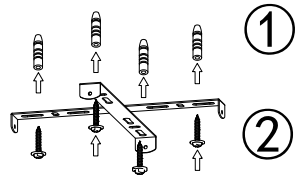

The ceiling

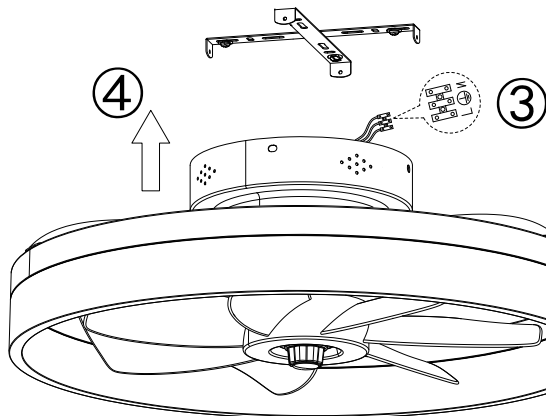

The ceiling

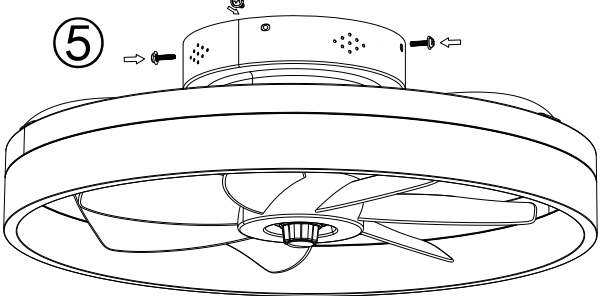

Turn on the power switch and press the 'SETUP' button within 2 seconds after hearing the 'drip'. The receiver beeps out two clicks, successfully matching the code.

**Tips: Before installation, the lamp should be tested for electricity. The lamp can be installed to the ceiling only in normal operation**

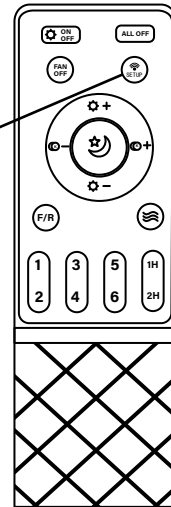

## Installation steps

- Step1 : Disassemble the hanging plate of the lamp, then the hole position of the hanging plate is measured and located on the ceiling by borrowing the hole position of the hanging plate.
- Step2 : Punch holes in the positioning mark according to the size of the expansion screw, then hammer the expansion screw into the hole with a hammer (leaving one centimeter outside) and then counterclockwise unscrew the nut and meson to lock the hanging plate. (If your ceiling is not concrete but a wooden suspended ceiling, use self-tapping screws directly to secure the cross-hanging panels).
- Step3 : Install the hanging plate on the ceiling with the washers respectively. Ensure that the mounting plate is connected with the ceiling firmly, and ensure that the hanging plate and the expansion screw are sufficient to bear the weight of the lamp body.
- Step4 : The main line of the lamp body should be checked if the lamp works normally or not by connect 110V power supply. It is recommended that professional electrician install the lamp.
- Step5 : Install the lamp hub on the hanging plate according to the hole position. please ensure that the lamp body and ceiling are securely connected.

## Attention

- 1 : Please read the assembly drawing carefully before installing and maintaining the lamps and lanterns, and keep it properly for future use after use.
- 2 : The power supply used should not exceed the specified range of voltage (rated voltage AC110V) for a long time ,or may cause damage to the lamp overheating.
- 3 : Please pay attention to check whether the cable and switch are in good condition before use, and ensure that the local voltage is consistent with the lamp voltage.
- 4 : Please turn off the power before installing the lamp.
- 5 : Do not install the lamp above the high temperature object, such as stove, gas, exhaust, cylinder, etc., which may damage the lamp.
- 6 : Please do not refit the lamps ,which may case of malfunction.
- 7 : Please clean and check regularly. Turn off the power before cleaning. Wipe the surface with a dry rubbing cloth. Do not wipe with acidic or alkaline chemical solvents, which will cause serious damage to the surface.

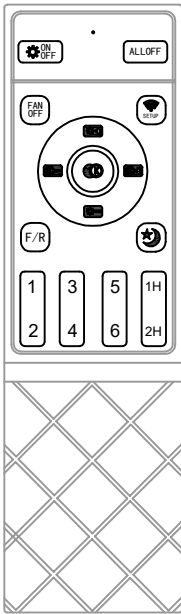

## APP



Remote control pair code: long press the "SET UP" key within 5 seconds after the lamp is just power-on, the buzzer rings 1 sound drop, indicating the success of the pair code.



**TUM OFF THE LIGHTS AND TURN ON THE LIGHTS**



**ALLOFF** General



night lamp



Three speed color temperature adjustment



Fan stop



Long press or click on this key to increase the brightness. It makes a ticking sound at the brightest time.



Long or click the key to turn dark. It makes a ticking noise in the darkest hour



Long press this key to increase the color temperature



Long press this key, the color temperature drops



The afn turns/reverses



Countdown > 1 drop > 1 hour



Countdown > 2 drop > 2 hour



1.2.3.4.5.6 Fan gear 1 gear minimum wind 6 gear is the maximum wind

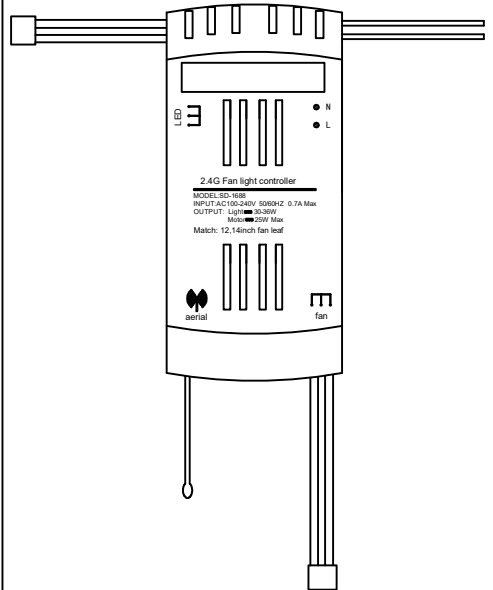

# CERTIFICATE OF COMPLIANCE

**Certificate Number** E476194  
**Report Reference** E476194-2020-11-06  
**Date** 2020-November-23

**Issued to:** Foshan Junfeng Wire and Cable Co Ltd  
No. 202, Building 1, Shiyou Industrial City, No.194, Junyi Road  
Shatou Community Residents Committee, Jun'an Town, Shunde District  
FoshanGuangdong 528329 CN

**This is to certify that  
representative samples of**

APPLIANCE WIRING MATERIAL - COMPONENT  
See Addendum Page for Product Designation(s).

Have been investigated by UL in accordance with the component requirements in the Standard(s) indicated on this Certificate. UL Recognized components are incomplete in certain constructional features or restricted in performance capabilities and are intended for installation in complete equipment submitted for investigation to UL LLC.

**Standard(s) for Safety:** See Addendum Page

**Additional Information:** See the UL Online Certifications Directory at <https://iq.ulprospector.com> for additional information

This *Certificate of Compliance* does not provide authorization to apply the UL Recognized Component Mark. Only the UL Follow-Up Services Procedure provides authorization to apply the UL Mark.

Only those products bearing the UL Recognized Component Mark should be considered as being UL Certified and covered under UL's Follow-Up Services.

Look for the UL Recognized Component Mark on the product.



Bruce Mahrenholz, Director North American Certification Program

UL LLC

Any information and documentation involving UL Mark services are provided on behalf of UL LLC (UL) or any authorized licensee of UL. For questions, please contact a local UL Customer Service Representative at <http://ul.com/aboutul/locations/>



# CERTIFICATE OF COMPLIANCE

Certificate Number E476194  
Report Reference E476194-2020-11-06  
Date 2020-November-23

This is to certify that representative samples of the product as specified on this certificate were tested according to the current UL requirements

SINGLE-CONDUCTOR THERMOPLASTIC-INSULATED WIRE  
1332

CSA C22.2 NO.210-15 APPLIANCE WIRING MATERIAL PRODUCTS  
UL 758 STANDARD FOR APPLIANCE WIRING MATERIAL



Bruce Mahrenholz, Director North American Certification Program

UL LLC

Any information and documentation involving UL Mark services are provided on behalf of UL LLC (UL) or any authorized licensee of UL. For questions, please contact a local UL Customer Service Representative at <http://ul.com/aboutul/locations/>



# CERTIFICATE OF COMPLIANCE

**Certificate Number** E476194  
**Report Reference** E476194-2020-11-07  
**Date** 2020-November-23

**Issued to:** Foshan Junfeng Wire and Cable Co Ltd  
No. 202, Building 1, Shiyou Industrial City, No.194, Junyi Road  
Shatou Community Residents Committee, Jun'an Town, Shunde District  
FoshanGuangdong 528329 CN

**This is to certify that  
representative samples of**

APPLIANCE WIRING MATERIAL - COMPONENT

Appliance Wire, Extruded FEP Insulated Singles, Class I, Group A, B, or A/B.

Have been investigated by UL in accordance with the component requirements in the Standard(s) indicated on this Certificate. UL Recognized components are incomplete in certain constructional features or restricted in performance capabilities and are intended for installation in complete equipment submitted for investigation to UL LLC.

**Standard(s) for Safety:** REFER ADDENDUM PAGE

**Additional Information:** See the UL Online Certifications Directory at <https://iq.ulprospector.com> for additional information

This *Certificate of Compliance* does not provide authorization to apply the UL Recognized Component Mark. Only the UL Follow-Up Services Procedure provides authorization to apply the UL Mark.

Only those products bearing the UL Recognized Component Mark should be considered as being UL Certified and covered under UL's Follow-Up Services.

Look for the UL Recognized Component Mark on the product.



Bruce Mahrenholz, Director North American Certification Program

UL LLC

Any information and documentation involving UL Mark services are provided on behalf of UL LLC (UL) or any authorized licensee of UL. For questions, please contact a local UL Customer Service Representative at <http://ul.com/aboutul/locations/>



# CERTIFICATE OF COMPLIANCE

Certificate Number E476194  
Report Reference E476194-2020-11-07  
Date 2020-November-23

This is to certify that representative samples of the product as specified on this certificate were tested according to the current UL requirements

UL 758 Appliance Wiring Material  
CSA C22.2 No. 210-15 Appliance Wiring Material Products



Bruce Mahrenholz, Director North American Certification Program

UL LLC

Any information and documentation involving UL Mark services are provided on behalf of UL LLC (UL) or any authorized licensee of UL. For questions, please contact a local UL Customer Service Representative at <http://ul.com/aboutul/locations/>



File E476194

Project 4789618255

November 7, 2020

REPORT

on

COMPONENT - Appliance Wiring Material

Foshan Junfeng Wire and Cable Co., Ltd  
Foshan, Guangdong, 528329 China

Copyright © 2020 UL LLC

UL LLC authorizes the above named company to reproduce this Report only for purposes as described in the Conclusion. The Report should be reproduced in its entirety; however to protect confidential product information, the Construction Details Descriptive pages may be excluded